

Hardware

Panel Jacks

Standard Size Round Hole Panel Jacks

T/C Code	Color	Square Face	Round Face	Price
K	Yellow	RSJ-K-S	RSJ-K-R	\$2.25
T	Blue	RSJ-T-S	RSJ-T-R	
J	Black	RSJ-J-S	RSJ-J-R	
E	Purple	RSJ-E-S	RSJ-E-R	
R/S	Green	RSJ-R/S-S	RSJ-R/S-R	
U	White	RSJ-U-S	RSJ-U-R	

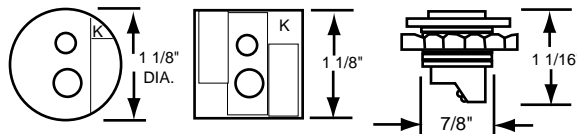

- 7/8" dia. cutout, 1-1/8" dia. bezel
- Mounts in round or "D" punch holes
- Round or square bezel to match your panel
- Color coded

Miniature Size Round Hole Panel Jacks

T/C Code	Color	Square Face	Round Face	Price
K	Yellow	RMJ-K-S	RMJ-K-R	\$1.95
T	Blue	RMJ-T-S	RMJ-T-R	
J	Black	RMJ-J-S	RMJ-J-R	
E	Purple	RMJ-E-S	RMJ-E-R	
R/S	Green	RMJ-R/S-S	RMJ-R/S-R	
U	White	RSJ-U-S	RMJ-U-R	

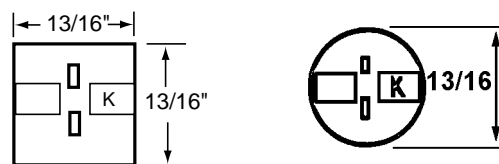

- 5/8" dia. cutout, 13/16" dia. bezel
- Mounts in round or "D" punch holes
- Round or square bezel to match your panel
- Color coded

5/8 Panel Hole

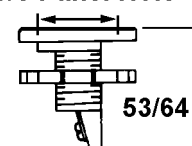

Miniature Panel Jacks

T/C Code	Alloy +	Alloy -	Color	Part Number	Price
K	Chromel	Alumel	Yellow	MPJ-K-F	\$2.25
T	Copper	Constantan	Blue	MPJ-T-F	2.25
J	Iron	Constantan	Black	MPJ-J-F	2.25
E	Chromel	Constantan	Purple	MPJ-E-F	2.25
R/S	Copper	Alloy #11	Green	MPJ-R/S-F	2.25
C	Alloy #405	Alloy #426	Red	MPJ-C-F	2.25
U	Copper	Copper	White	MPJ-U-F	2.25

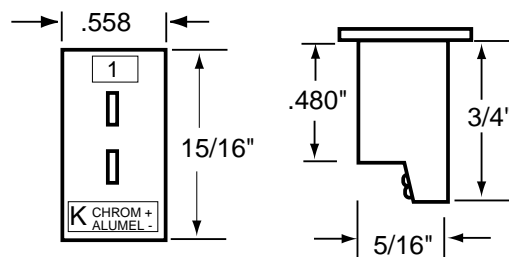

- 0.318" x 0.656" cutout required
- 0.562" centers horizontally
- 0.938" centers row to row minimum
- Spring clip included

Standard Panel Jacks

T/C Code	Alloy +	Alloy -	Color	Part Number	Price
K	Chromel	Alumel	Yellow	SPJ-K-F	\$4.25
T	Copper	Constantan	Blue	SPJ-T-F	4.25
J	Iron	Constantan	Black	SPJ-J-F	4.25
E	Chromel	Constantan	Purple	SPJ-E-F	4.25
R/S	Copper	Alloy #11	Green	SPJ-R/S-F	4.25
C	Alloy #405	Alloy #426	Red	SPJ-C-F	11.25
U	Copper	Copper	White	SPJ-U-F	4.25

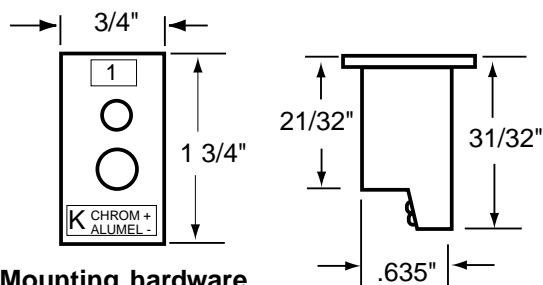

- Mounting hardware has been eliminated by including the retaining clip as a part of the body design.
- Simply snap into a 1.195" x 0.635" cutout.